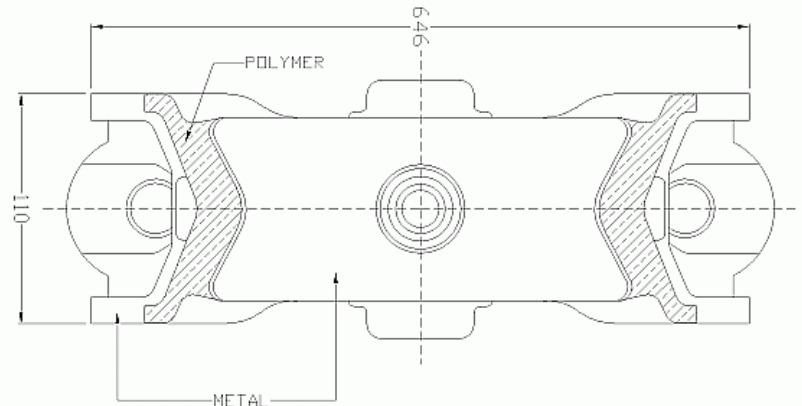

## Anti-Vibration Solutions for Railways, Automotive and Other Industries

Industry leader in manufacturing over hundreds of Rubbers and Thermoplastics based Moulded Anti-Vibrations, Mounts, Buffers, Dampers, Suspensions, Torsion Blocks, Silent Blocks, Bushes, Metal Bonded Parts and other polymeric engineering products for static and dynamic application for Railways and Roadways Sector.

**BRIEF DESCRIPTION**

Elastic Engine Suspension is used as suspension element in few specific Locomotive and support carrying entire weight engine reducing vibration, noise and damage that may occur during train running condition. The cast steel metal part is bonded with oil resistant rubber compound in such a way so that it may create a suspension effect. This suspension pad is subjected to static and dynamic loadings both in compressive and shear modes simultaneously during operating condition. These can withstand wide climatic variation prevailing in the country without much physical deterioration and change in the compression and shear stiffness characteristics.

**PRODUCT APPLICATION**

Rubber to Metal Bonded Suspension for Dynamic Application

**WORKING LOAD RANGE**

500 to 2000 kg dynamic vertical load

**WORKING TEMPERATURE RANGE**

Works in ambient temperature between -10°C to 60°C. This range may be customised as per users' requirement.

**MOSTLY USED IN**

Diesel Locomotive

**RELATED DOCUMENTS**

-