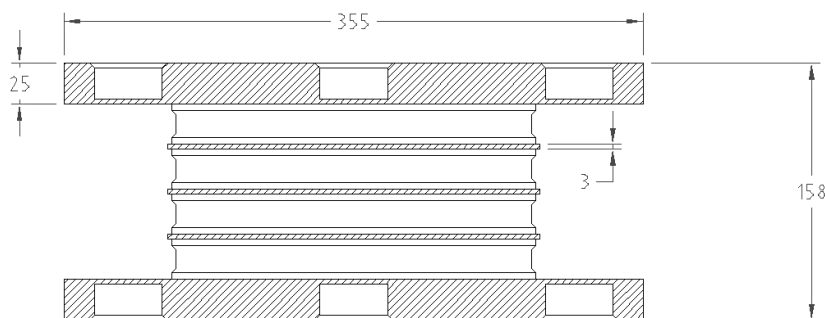

Industry leader in manufacturing over hundreds of Rubbers and Thermoplastics based Moulded Anti-Vibrations, Mounts, Buffers, Dampers, Suspensions, Torsion Blocks, Silent Blocks, Bushes, Metal Bonded Parts and other polymeric engineering products for static and dynamic application for Railways and Roadways Sector.

**BRIEF DESCRIPTION**

Sandwich Mounting is used in Broad Gauge Electric Multiple Units, generally used as short distance public transport train, in the nose suspension arrangement of traction motor. The product is held between the bogie frame and traction motor nose lugs and is subjected to dynamic & variable compressive and shear force. The product is preloaded during fitment and exposed to prevailing weather of dusty and humid conditions with minor chance of oil contact.

PRODUCT APPLICATION

Rubber to Metal Bonded Damper for Dynamic Application

WORKING LOAD RANGE

2000 kg to 3000 kg dynamic, intermittently 3900 kg maximum.

WORKING TEMPERATURE RANGE

Works in ambient temperature between -10°C to 70°C. This range may be customised as per users' requirement.

MOSTLY USED IN

Electric Multiple Units

RELATED DOCUMENTS

- 1) SKEL-3148
- 2) ER/KPA/EL/TM/2HE/166A
- 3) R-49/75 (EMU)